

doughXpress

Model No.

TXW-1620

TXW-2025 Tortilla Flat Grills



16"x20"



20"x25"

DIMENSIONS

	16"x20"	20"x25"
Width:	17 in, 43.18 cm	20 in, 50.8 cm
Height:	6.16 in, 15.65 cm	6.22 in, 15.8 cm
Depth:	21.43 in, 54.43 cm	25.69 in, 65.25 cm

WEIGHT

	16"x20"	20"x 25"
Warmer Only:	15 lbs.	25 lbs.
Shipping:	20 lbs.	30 lbs.

ELECTRICAL

16"x20"(120v)	16"x20"(220v)	20"x 25"
120v/60Hz	220v/60Hz	220v/60Hz
1750 Watts	2000 Watts	4300 Watts
14.5 Amps	14.5 Amps	18 Amps
Standard Grounded NEMA Plug on 120v		
6-15P NEMA Plug on 16x20 220v		
6-20P NEMA Plug on 20x25 220v		

TEMPERATURE RANGE

OFF - 425°F, 218°C upper & lower platens

What better way to entice the appetite then with the sight and smell of fresh hot tortillas. The TXW-1620 or TXW-2025 Tortilla warmer combined with our tortilla press from doughXpress™ produces a great, fresh tortilla taste that keeps the customers coming back for more! Our tortilla warmers provide even heating on the standard 16" x 20" or large 20" x 25" surface. Our heating rods are similar to those found in industrial ovens so they heat quickly, work efficiently and last longer.

FEATURES INCLUDE:

- On/Off indication light.
- Temperature control dial.
- Single calrod for even heating; no cold spots.
- Temperature dial settings range from 200°-410°F.
- Adjustable legs for leveling.
- Optional Xylan® coating.
- Made in U.S.A.
- Add a tortillaXpress tortilla press complete package.
- Not to be used for grease producing food items.

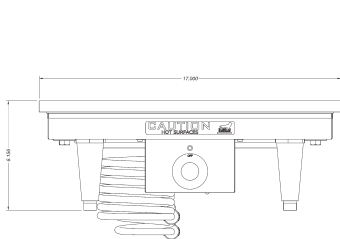

TXW-1620

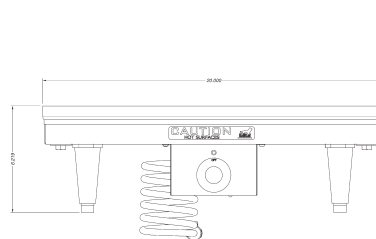
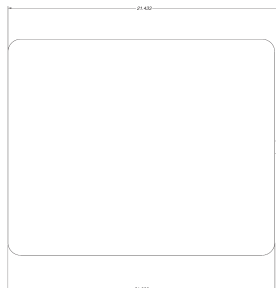

TXW-2025

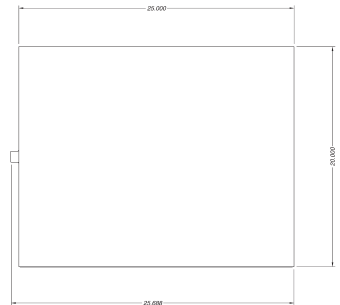

doughXpress
HIX Corporation Food Division
 Product improvement may require us to change specifications without notice.
 Revised April 2009

DOUGHXPRESS
 1201 E. 27th Terrace
 Pittsburg, KS 66762 USA

Toll Free: (800) 835-0606 ext.205
 Tel: (620) 231-8568 ext.205
 Fax: (866) 565-3189

doughxpress@hixcorp.com or visit www.doughxpress.com